

**Conference Centers**

| Room Name            | Dimension | Sq. Feet | Ceiling Ht. | Theater | Classroom | Rounds |
|----------------------|-----------|----------|-------------|---------|-----------|--------|
| A-I                  | 156 x 74  | 11544    | 17          | 1600    | 1000      | 800    |
| A, C, D, E, F        | 28 x 32   | 896      | 17          | 100     | 50        | 50     |
| B, G, H, J           | 28 x 27   | 756      | 17          | 80      | 48        | 40     |
| I                    | 34 x 72   | 2448     | 17          | 220     | 132       | 100    |
| Upper Dells Ballroom | 71 x 44   | 3124     | 12          | 340     | 180       | 214    |
| Grand Ballroom       | 85 x 65   | 5525     | 17          | 600     | 315       | 400    |
| Riverview Rm. North  | 98 x 66   | 6358     | 11.8        | 650     | 300       | 250    |
| Riverview Rm. South  | 68 x 73   | 4950     | 11.8        | 550     | 260       | 230    |
| Riverview Ballroom   | 166 x 139 | 11300    | 11.8        | 550     | 300       | 420    |

# Chula Vista Resort

## Facility Layout



Lower Atrium Level  
Below Conference Center

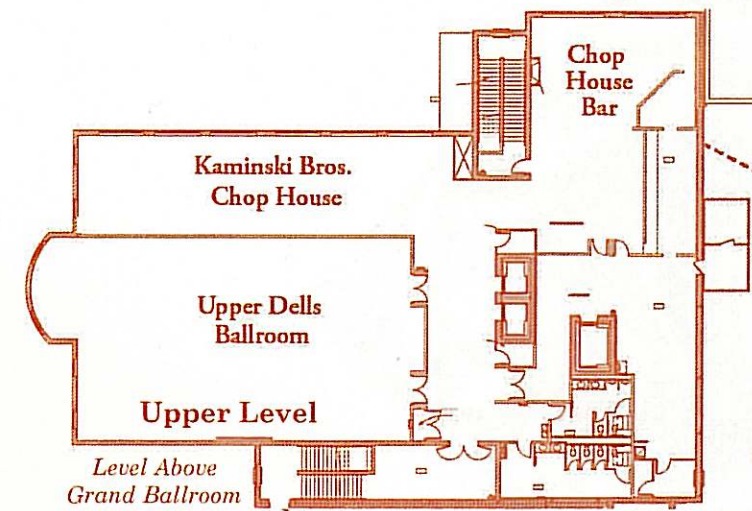

Level Above  
Grand Ballroom

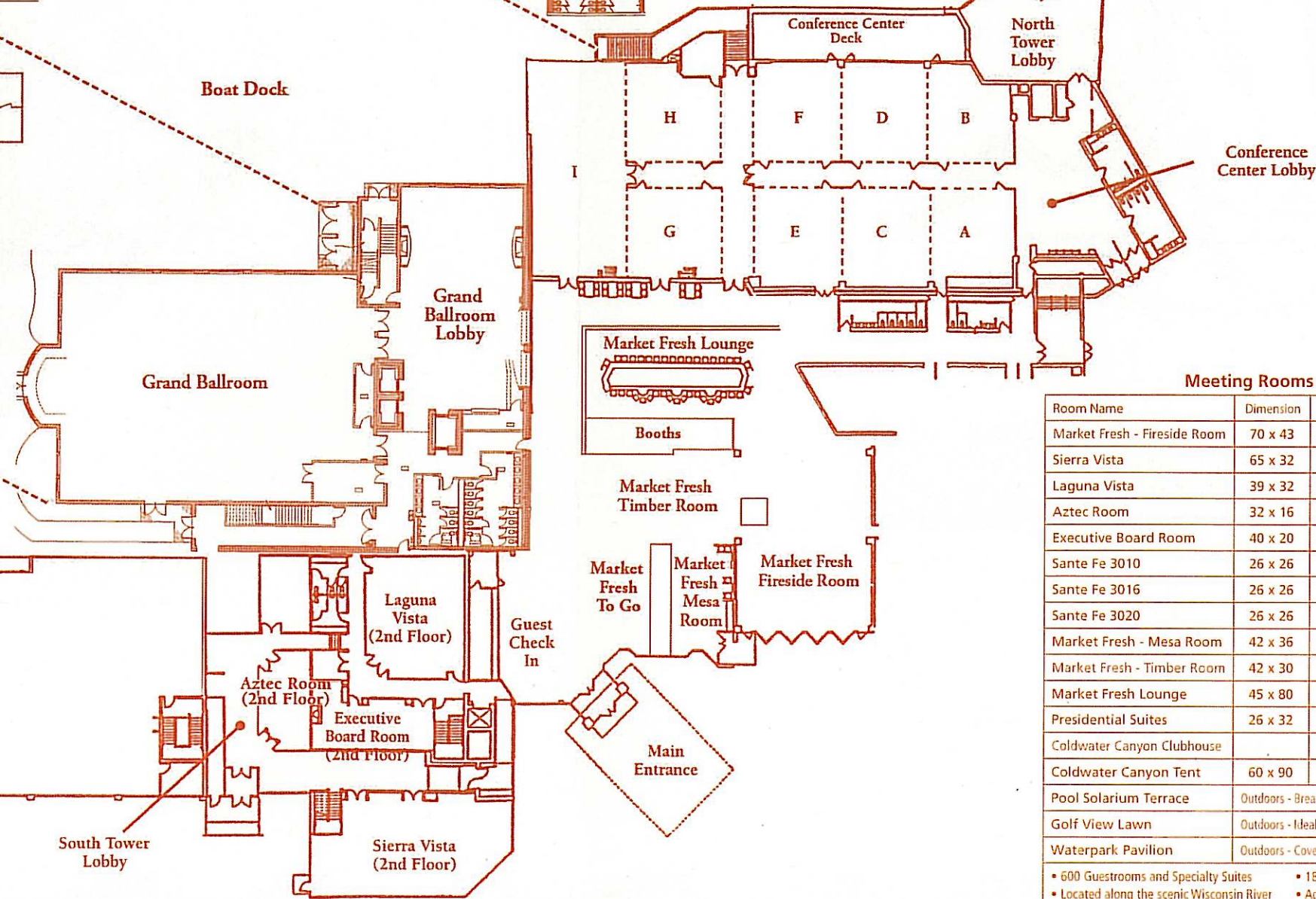

**Meeting Rooms and Additional Facility Areas**

| Room Name                    | Dimension   | Sq. Feet | Ceiling Ht. | Theater | Classroom | Rounds | Conference |
|------------------------------|---|----------|-------------|---------|-----------|--------|------------|
| Market Fresh - Fireside Room | 70 x 43   | 3010     | 22          |         |           | 200    |            |
| Sierra Vista                 | 65 x 32   | 2080     | 10          | 225     | 110       | 100    |            |
| Laguna Vista                 | 39 x 32   | 1248     | 9           | 90      | 60        | 80     |            |
| Aztec Room                   | 32 x 16   | 512      | 8           | 40      | 20        | 30     |            |
| Executive Board Room         | 40 x 20   | 800      | 9           |         |           |        | 20         |
| Sante Fe 3010                | 26 x 26   | 676      | 8           | 50      | 32        | 40     |            |
| Sante Fe 3016                | 26 x 26   | 676      | 8           | 50      | 32        | 40     |            |
| Sante Fe 3020                | 26 x 26   | 676      | 8           | 50      | 32        | 40     |            |
| Market Fresh - Mesa Room     | 42 x 36   | 1512     | 8           |         |           | 32     |            |
| Market Fresh - Timber Room   | 42 x 30   | 1260     | 11          |         |           | 84     |            |
| Market Fresh Lounge          | 45 x 80   | 3600     | 11          |         |           |        |            |
| Presidential Suites          | 26 x 32   | 832      | 8           | 24      | 12        | 20     | 12         |
| Coldwater Canyon Clubhouse   |   |          |             |         |           | 80     |            |
| Coldwater Canyon Tent        | 60 x 90   | 5400     |             | 600     |           | 350    |            |
| Pool Solarium Terrace        | Outdoors - Breathtaking views of the Upper Dells River for meal functions up to 100 people.   |          |             |         |           |        |            |
| Golf View Lawn               | Outdoors - Ideal for weddings, outdoor BBQs, team building events for up to 1000 people.      |          |             |         |           |        |            |
| Waterpark Pavilion           | Outdoors - Covered area set in the heart of the mini golf and waterpark for up to 200 people. |          |             |         |           |        |            |

- 600 Guestrooms and Specialty Suites
- 18-Hole Adjacent Golf Course - Cold Water Canyon
- Located along the scenic Wisconsin River
- Additional amenities include Spa Del Sol, Market Fresh Lounges, 3 Dining Areas, Wind River Gift Shop, Indoor & Outdoor Waterpark.

Guest Suites  
Condominiums  
and  
Indoor Waterpark

South Tower Wing

South Tower  
Lobby

Sierra Vista  
(2nd Floor)

Aztec Room  
(2nd Floor)

Executive  
Board Room  
(2nd Floor)

Laguna  
Vista  
(2nd Floor)

Guest Check  
In

Main  
Entrance

Market  
Fresh  
To Go

Market  
Fresh  
Mesa  
Room

Market Fresh  
Fireside Room

Market Fresh Lounge

Booths

Market Fresh  
Timber Room

Grand  
Ballroom  
Lobby

Grand Ballroom

North  
Tower  
Lobby

Conference Center  
Deck

Presidential  
Suites

North Tower Wing

Sante  
Fe  
3010

Sante  
Fe  
3016

Sante  
Fe  
3020

Ground Floor

Boat Dock

North

South

Lower Atrium Level  
Below Conference Center

Pre-function

Pre-function

Outdoor Riverview  
Terrace

Atrium